

- NOTES:**
1. It is proposed that extension and rehabilitation of the quarry will provide for a meadow land and wetland complex with water being allowed to outlet at the southeast corner of the site where it will enter a shallow creek and drain off-site towards the York River
 2. Extraction of bedrock will occur below the established water table.
 3. Private well locations within 120 meters of the site and within lands currently owned by the applicant are noted on the plan.
 4. Six groundwater monitoring wells were drilled on site in 2009 as shown and water level monitoring data has been collected from the wells since 2009 and is ongoing.

- LIST OF REFERENCES:**
- a) CONTOUR MAPPING - Land Inventory Ontario @2011 Queen's Printer
 - b) NATURAL ENVIRONMENTAL LEVELS 1 & 2 REPORT - Robn E. Craig - July 17, 2011
 - c) AND ENVIRONMENTAL IMPACT STATEMENT
 - d) TRAFFIC IMPACT STUDY - Tranplan Assoc. - May 12, 2012
 - e) PLANNING JUSTIFICATION REPORT - EcoVue Consulting Services - June 14, 2012
 - f) ACOUSTICAL ASSESSMENT REPORT - High Williamson Assoc. Ltd. - May 13, 2013
 - g) LEVEL 2 HYDROGEOLOGICAL ASSESSMENT - MTE Consultants Inc. - March 27, 2015
 - h) STAGE 1 & 2 ARCHAEOLOGICAL ASSESSMENT - Ken Seizeze - February 2011
 - i) CLEARANCE LETTER PROVIDED - Ministry of Tourism & Culture - September 2012
 - j) DRAINAGE ASSESSMENT - MTE Consultants Inc. - March 27, 2015
 - k) BOUNDARY SURVEY - Gag-Berby Surveying - January 2014
 - l) ZONING INFORMATION - Town of Bancroft Zoning By-Law 27-2006 - January 2014
 - m) BLAST IMPACT ANALYSIS - Exploitech - February 2014

- SITE DESCRIPTION:**
- a) Licensed area is 35 hectares
 - b) The licensed area is currently forested and managed as a forest reserve. Timber harvest occurs in response to market needs.
 - c) The licensed area is hilly with two predominant "peaks" that rise above the flat existing occupied by about 60 metres. The site slopes generally from the west to the east.
 - d) The licensed area is predominantly covered by deciduous trees (maple, birch, beech and willow) with the noted presence of coniferous species (cedar, pine, balsam and hemlock), as well. The area is generally undisturbed forest.
 - e) All buildings located within 120m of the site and within lands currently owned by the applicant are noted on the site plan.
 - f) There is no evidence of fencing on any of the boundaries of the licensed area.
 - g) No stockpiles or berms of topsoil, overburden, aggregates, recyclables or scrap are currently on site.
 - h) The existing operations are serviced by two wells that support the milling operations and provide potable water to the on-site workers.
 - i) All fuel tanks are shown on plan.
 - j) The Natural Environmental Report and Impact Statement conducted by the consultant biologist identified no Areas of Natural or Scientific Interest (ANSI), Vulnerable, Threatened or Endangered Species, Wildlife or Fish Habitat.
 - k) There are no excavation faces or rehabilitated areas on site.
 - l) There are no processing areas currently on site.

- SURFACE DRAINAGE AND GROUNDWATER TABLE:**
- a) A shallow stream flows outside the licensed area, on and through the proponent's property and eventually discharges to the York River. There are three woodland pond areas on site, located in the central area and along the south-west boundary. There are no evident inlets or outlets to the ponds but the water remains all summer, decreasing in size due to the effects of evaporation.
 - b) The groundwater table varies from approximately 374.0m to 356.5m flowing in a northeasterly direction towards the York River as shown on Figure 6 of the hydrogeological investigation completed by MTE Consultants Inc. (March 27 2015)

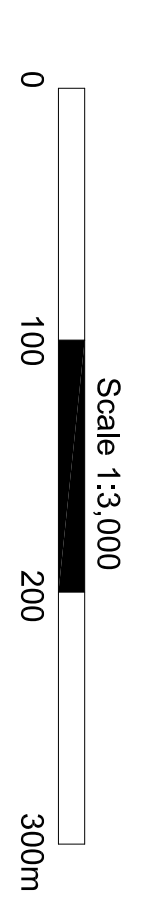

Site Plan Override		Site Plan Amendments	
The following conditions illustrated on these plans vary from the requirements of ROS 1990 Chapter A.8; as provided for under Section 15, RRO 1990.			
Item	Section	No.	Date
Five (5) metre contours are shown in lieu of one (1) - two (2) metre contours due to the extreme elevation differential of the site.	1.1.15		

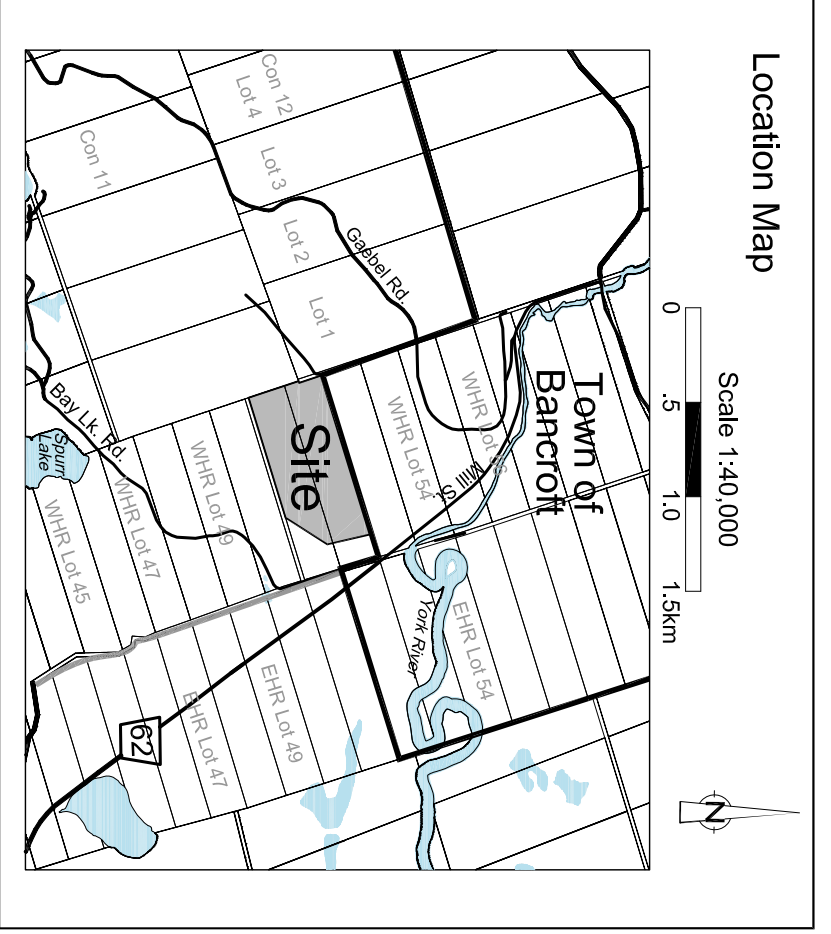

This site plan is prepared under the Aggregate Resources Act for a Class "A" Licence Category 2 Quarry Below Water

Freymond Aggregates

Existing Features Pages 1 of 4

Quarry Location:
Part of Lots 51 and 52, Concession W.H.R.
Township of Faraday
County of Hastings

Quarry Licensed To:
Freymond Lumber Ltd.
RR #1, 2287 Bay Lake Road
Bancroft, Ontario K0L 1C0

I acknowledge and shall carry on the operation of this site in accordance with the plan upon which my license is based.

Applicant Name: _____ Date: _____

Site Plans Approved By: _____ Date: _____

Ministry of Natural Resources _____ Date: _____

Designed and Prepared By: **ECOVUE** consulting services inc. www.ecovueconsulting.com

In Conjunction With **MTE** Engineers | Scientists | Surveyors www.mtes.com (Surface Drainage and Hydrogeology)

Date: _____

Printed March 30 2015