

Final Rehabilitation Notes:

Once Phase 2 floor elevations and side slope have been achieved, rehabilitation of the site will proceed as indicated on the drawings with the installation of vegetative nodes and water pool (filled through natural groundwater and surface run off). The final elevation of the groundwater table will be under the quarry floor, as anticipated in the hydrogeological report prepared by MTE Consultants Inc. Any water seepage from quarry slopes will be picked up and drained by sheet drainage to the collection swale. Little water will be retained on-site except that held in storage by the meadowland wetland complex to be established on-site.

All quarry faces will be backfilled with unmarketable, on-site materials to the required 2:1 slopes.

The sequence of the rehabilitation, once Phase 2 is complete, shall be as follows and in accordance with the recommendations provided by the Environmental Consultant, Robin E Craig.

Constructed berms previously created from site soil and topsoil shall be used to rehabilitate the site. These may be supplemented with clean, inert imported soil if quantities prove insufficient to rehabilitate the site as recommended.

At the request of MNR, the licensee/permittee will conduct random sampling of the imported material to ensure that it meets the Ministry of the Environment's (MOE) criteria under Table 1 of MOE's Soil Ground Water and Sediment Standards for Use Under Part XV.1 of the Environmental Protection Act. Sampling results will be provided to MNR upon request. Notwithstanding the above, where the imported material is not being placed within 1.5 metres of the surface, the criteria under Table 1 for sodium adsorption ration and electrical conductivity do not have to be met.

The use of native soils will provide a source for re-establishment of the native species.

Rehabilitation nodes of a minimum of 900 square metres per node will be created on the quarry floor and slopes. Organic material and topsoil will be constructed to variable depths within the node to a thin (100mm) depth) soil apron constructed beyond the entire node and joining the nodes.

Native shrubs and trees will be planted in accumulations of uncompacted topsoil to form zones of rehabilitation nodes. Rehabilitation zones will connect to undisturbed setbacks and other areas outside of the extraction limits.

Native tree species will include species identified in the environmental report prepared by Robin E. Craig (October 2011). These species include but are not limited to Eastern White Pine, Eastern White Cedar, Red Pine, Sugar Maple, White Birch, Balsam and Poplar.

Native shrubs, vines and flowers will include those in the Craig report including but not limited to Fly Honey-suckle, Red Osier Dogwood, Prickly and Smooth Gooseberry, Red Raspberry, Slender Willow, Herbaceous Carrion-flower, Leatherwood and Virginia Creeper.

Species will be planted in mixed groups to avoid monoculture plantations.

The quarry floor outside the nodes shall be graded to infill fissures and create small wetlands (Pool Areas) and potential amphibian breeding habitat. The Pool Areas shall be accomplished in consultation with a professional, qualified in wetland restoration and amphibian habitats.

Planting plans may be reviewed with the Ministry of Natural Resources and Forestry, if required. The implementation of the plans shall be by competent professionals in the field of vegetative restoration.

Planting will be accomplished by hand or machine, whichever is appropriate.

Drainage will be from west to east in general compliance with pre-extraction patterns. Although extraction will occur below the water table, the site will not be underwater (ie. a lake) because the rehabilitated quarry floor will drain the grading to the southeast corner. Natural vegetation and water pools will be established on the quarry floor to create a meadowland wetland complex. The intent is to create an area similar to that existing prior to extraction. This consists of indigenous forest, rock berms, wetlands and meadows.

No roads will be left on site within the extraction area except for access to adjacent lands to the north.

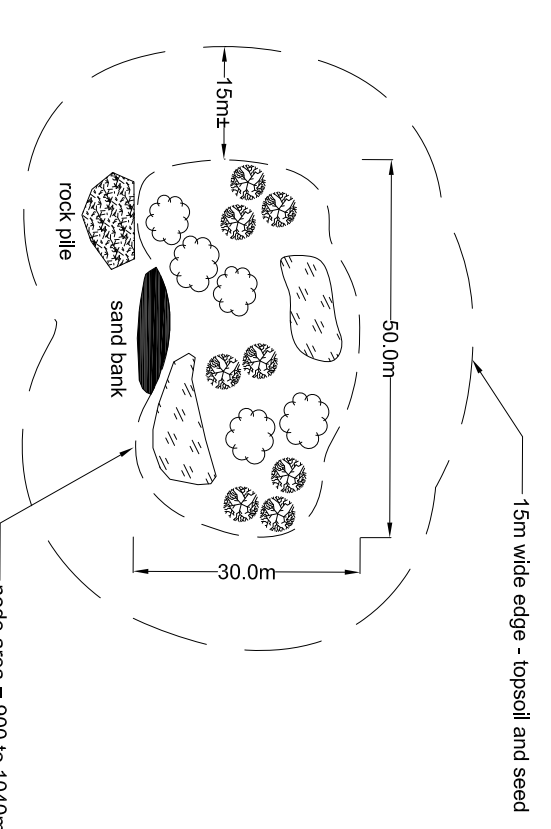

Typical Rehabilitation Node
N.T.S.

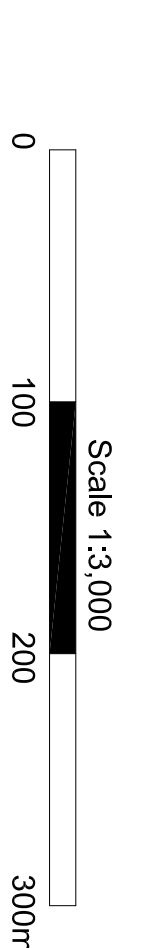

Site Plan Override		Site Plan Amendments	
The following conditions illustrated on these plans vary from the requirements of the 1990 Chapter R.3, as provided for under Section 15, R.R.O. 1990.		Date	Amendment
Item	Section		

In Conjunction With		Date	

Typical Slope Rehabilitation Detail
Scale N.T.S.

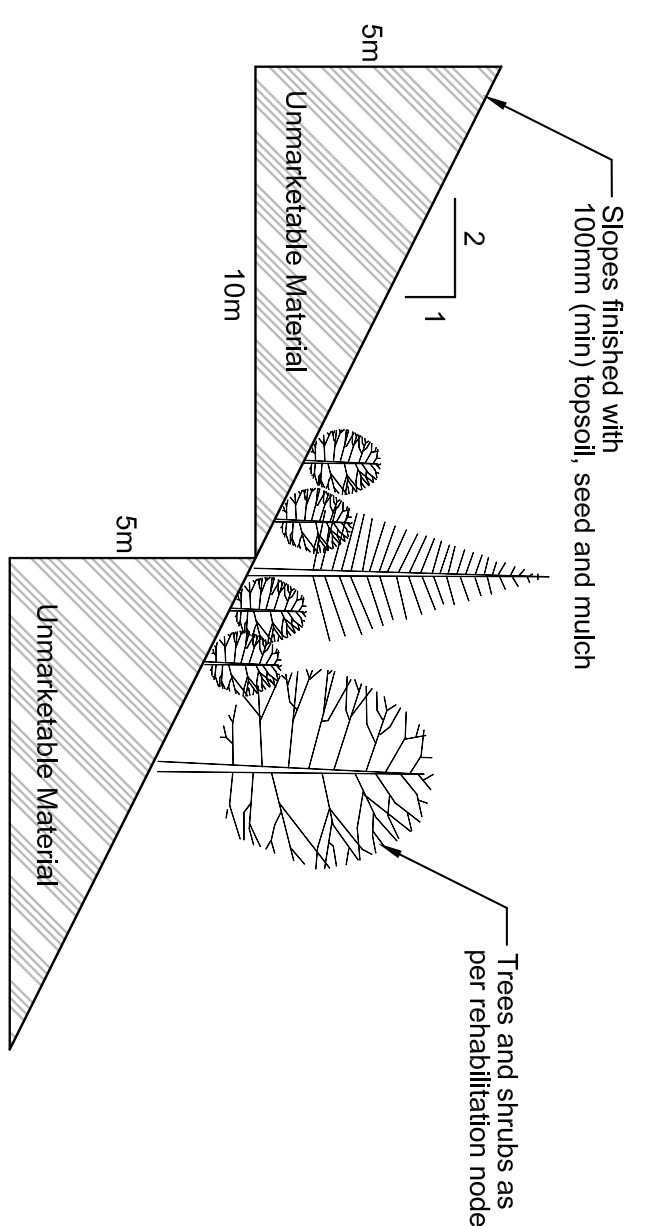

Typical Pool Area
Scale N.T.S.

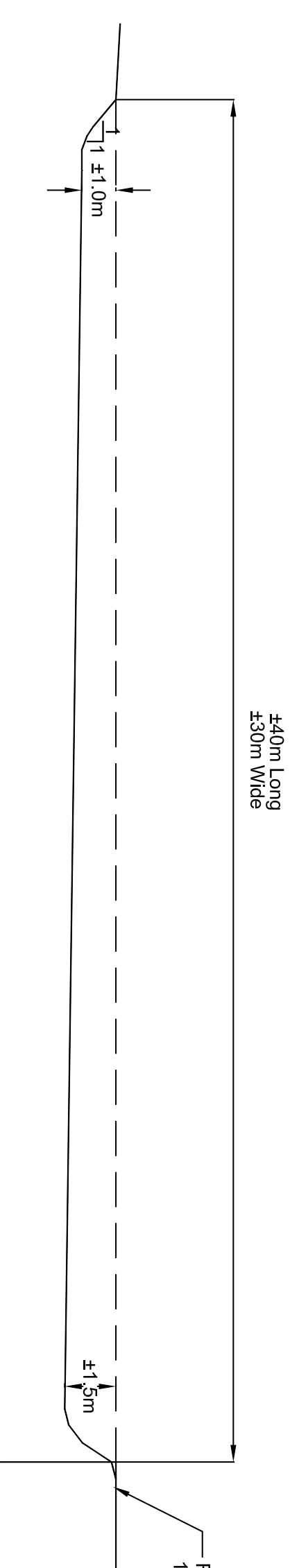

(Final Details to be Determined at Time of Final Rehabilitation)

Location Map

Scale 1:40,000

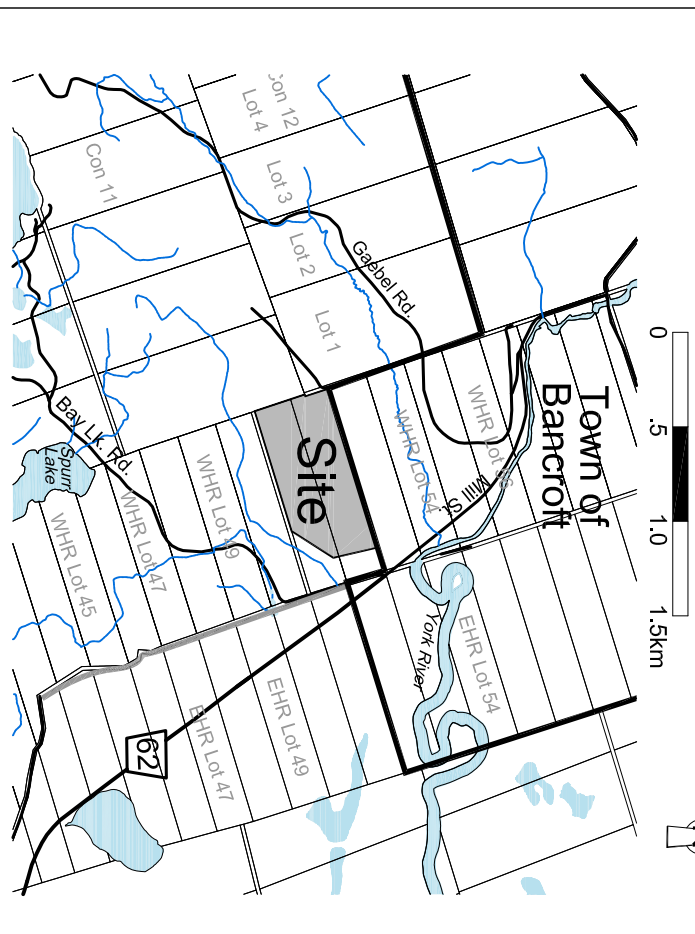

Legend

- Boundary of Lands Owned by Applicant
- Proposed Licensed Boundary
- Limit of Excavation
- Lot Line
- Existing Building
- Existing Water Course
- Existing Enhancements
- Final Surface Water Flow Direction
- Permanent (Phase 2) Swale
- Rehabilitation Node
- Pool

This site plan is prepared under the Aggregate Resources Act for a Class 'A' Licence Category '2' Quarry Below Water

Fremmond Aggregates

Rehabilitation Plan

Pages 3 of 4

Quarry Location:
Part of Lots 51 and 52, Concession W.H.R.,
Township of Faraday
County of Hastings

Quarry Licensed To:
Fremmond Lumber Ltd.
RR #1, 2287 Bay Lake Road
Bancroft, Ontario K0L 1C0

I acknowledge and shall carry on the operation of this site in accordance with the plan upon which my license is based.

Applicant Name: _____ Date: _____

Site Plans Approved By: _____ Date: _____

Ministry of Natural Resources: _____ Date: _____

Designed and Prepared By:

 www.ecovueconsulting.com

Engineers | Scientists | Surveyors

 www.mtes.com
 (Surface Drainage and Hydrogeology)

Printed March 30 2015