

Cross Section Locations
Scale - N.T.S.

- Technical Report Recommendations / Mitigation**
- Acoustical Study**
Refer to Section 5 of Hugh Williamson Associates Inc. Report, May 15 2013
 - Traffic Impact Study**
Refer to Section 5 of Trampen and Associates Report, May 15 2012
 - Environmental Impact Statement**
Refer to Section 5 of Robin Craig Environmental Consultant Report, October 2011
 - Stage 1 Archaeological Assessment**
Refer to Section 5 of Ken Swaze Archaeological Consultant Report, February 2011
 - Level 2 Hydrogeological Investigation**
Refer to Section 9 of MTE Report, March 27, 2015
 - Blasting Impact Analysis**
Refer to Page 17 of Explotech Report, February 18, 2014

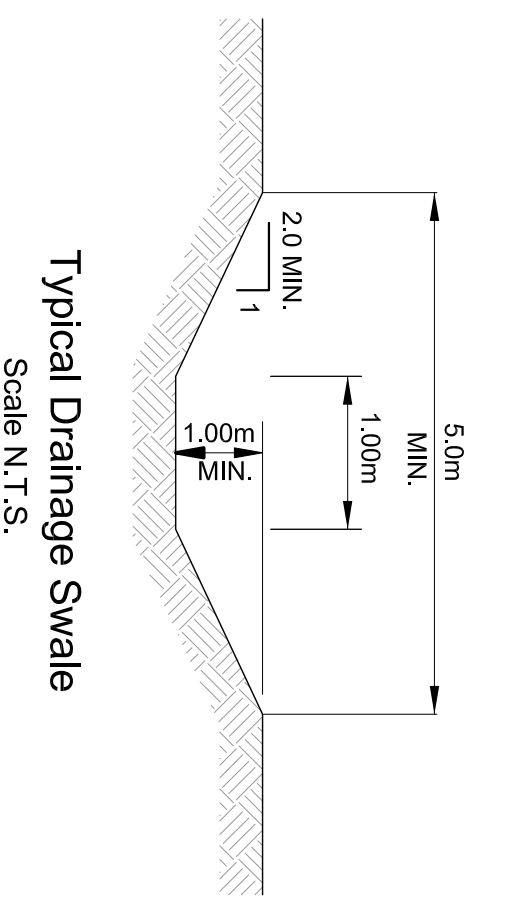
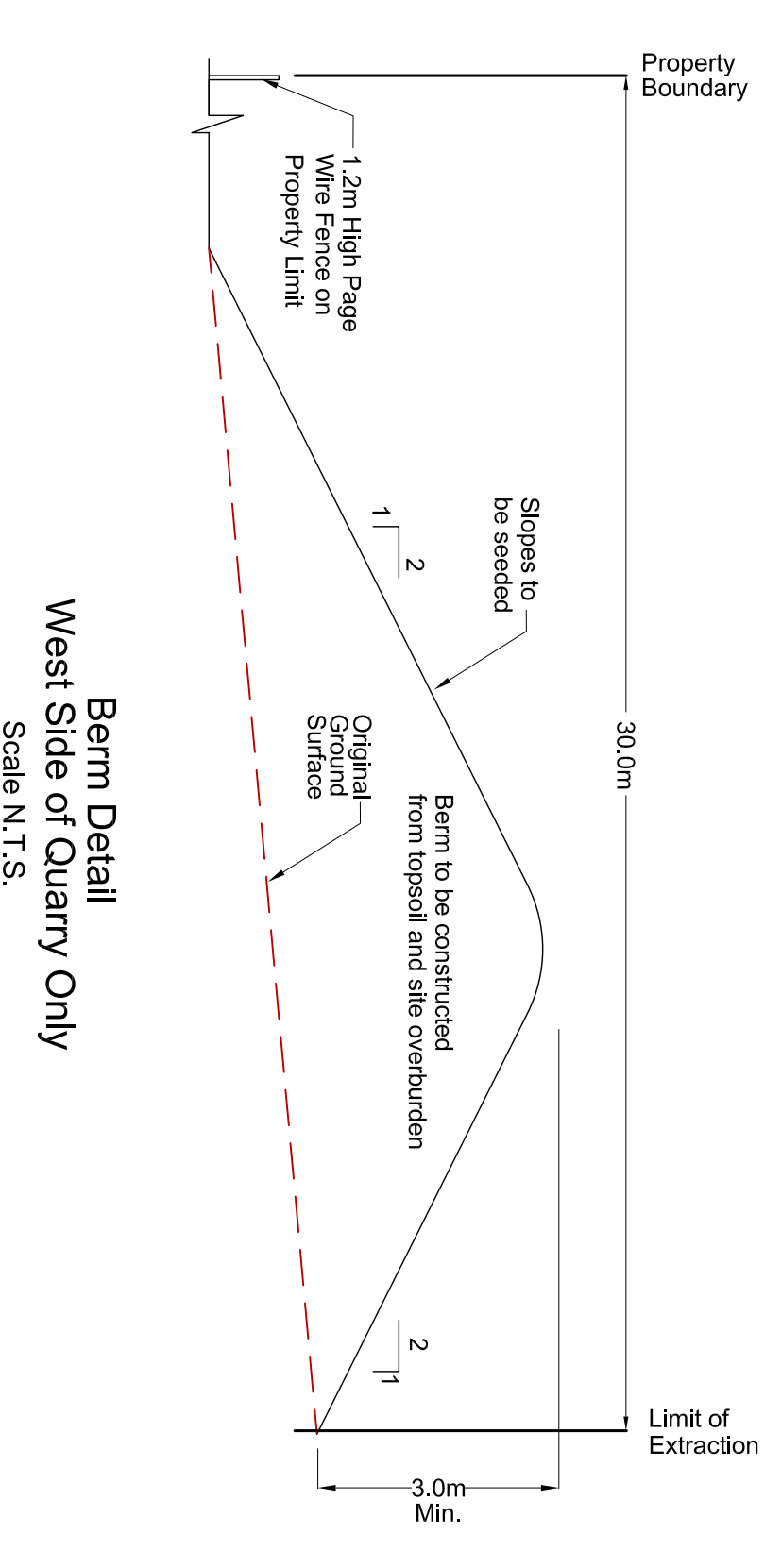

Site Plan Amendments

Item	Section	No.	Date	Submission/Amendment	Approved By
<p>Site Plan Override</p> <p>The following conditions illustrated on these plans vary from the requirements of RCO, 1990 Chapter A.8, as provided for under Section 15, RRO 1990.</p>					

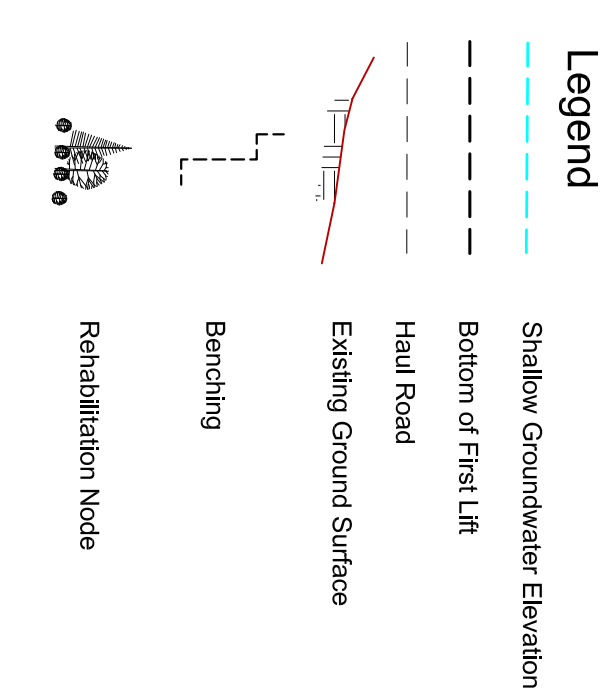
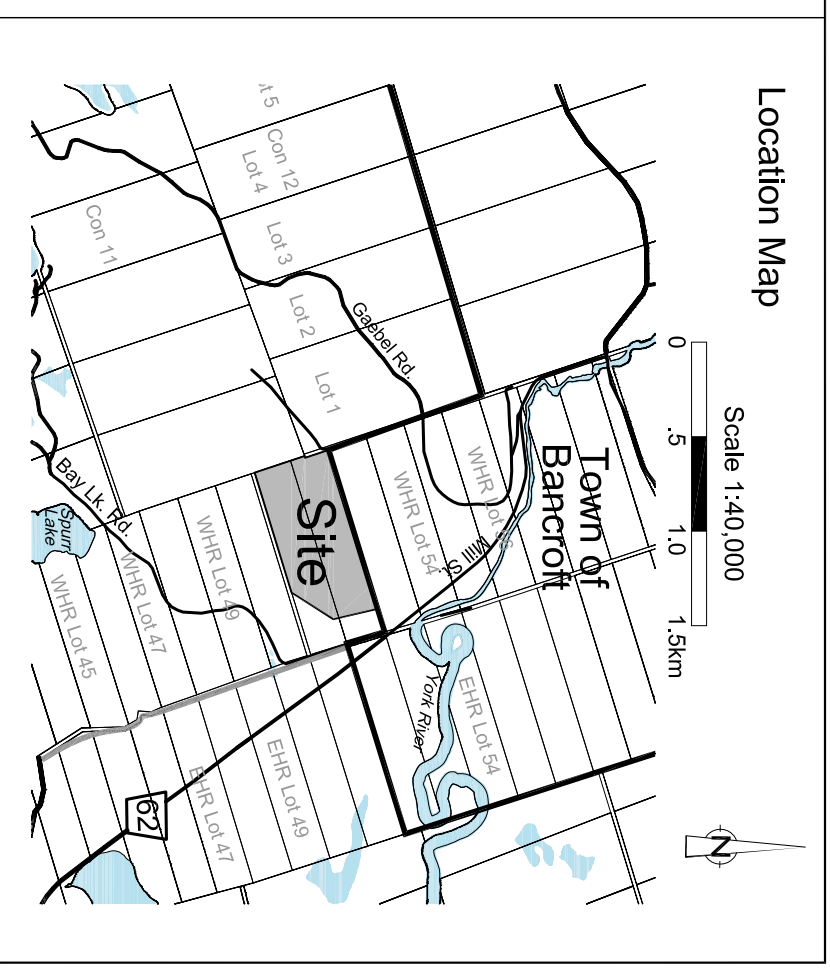

**Freymond Aggregates
Typical Recommendations
and Cross Sections**
Pages 4 of 4

This site plan is prepared under the Aggregate Resources Act for a Class A License Category 2, Quarry Below Water

Quarry Location:
Part of Lots 51 and 52, Concession W.H.R.
Township of Faraday
County of Hastings

Quarry Licensed To:
Freymond Lumber Ltd.
RR #1, 2287 Bay Lake Road
Barrow, Ontario K0L 1C0

I acknowledge and shall carry on the operation of this site in accordance with the plan upon which my license is based.

Applicant Name _____ Date _____

Site Plans Approved By: _____ Date _____

Ministry of Natural Resources _____ Date _____

Designed and Prepared By: _____ Date _____

ECOVIVE
consulting services inc.
www.ecoviveconsulting.com

In Conjunction With

MTE
Engineers | Scientists | Surveyors
www.mte85.com
(Surface Drainage and Hydrogeology)

Date _____